

# APP SYSTEMS

## TABLE OF CONTENTS

Specification Nomenclature

APP Warranty Matrix

APP-C-2-T

APP-C-3-T

APP-C-4-T

APP-I-2-T

APP-I-3-T

APP-I-4-T

APP-IN-2-T

APP-IN-3-T

APP-IN-4-T

APP-N-2-T

APP-N-3-T

APP-N-4-T

APP-IN-2-CF

# SPECIFICATION NOMENCLATURE

Please note: Each CertainTeed roof system specification includes multiple base, interply (if applicable) and cap sheet options. Warranty durations are dependent on both system specification and product pairing.

CertainTeed publishes the Commercial Roof Systems Specifications to guide in the specification of low-slope roof systems. The specifications are classified in alphanumeric combinations such as BUR(M)-N-5-A where:

Cap Sheet	(Surfacing)	Substrate	Number of Plies	Cap Application
<b>SA</b> Self Adhered	<b>(G)</b> Gravel Surface	<b>C</b> Non-nailable/ Non-insulated Concrete	<b>2, 3, 4, 5</b>	<b>S</b> Self Adhered
<b>APP</b> Atactic Polypropylene	<b>(M)</b> Mineral Surfaced Cap Sheet	<b>I</b> Insulated		<b>T</b> Torch Welded
<b>SBS</b> Styrene Butadiene Styrene	<b>(S)</b> Smooth	<b>IN</b> Any substrate with base sheet mechanically attached through insulation		<b>A</b> Hot Asphalt
<b>BUR</b> Built Up Roofing		<b>N</b> Mechanically Attached, Non-insulated		<b>C</b> Cold Process (adhesive)
				<b>CF</b> CertaFast (base sheet application)

## SPEC CONVERSION CHART

### NEW CT SPEC

APP-R-1-T	APP-C-2-T	APP-C-3-T	APP-I-2-T	APP-I-3-T	APP-IN-2-T	APP-IN-3-T	APP-N-2-T	APP-N-3-T
<b>OLD CT SPEC(S)</b>								
	GTA-C-B2 GTA-FR-C-B2 STA-C-B2	GTA-C-B3 GTA-FR-C-B3 STA-C-B3	GTA-C-B2/IC GTA-C-B2/IN GTA-C-B2/IS GTA-FR-C-B2/IC GTA-FR-C-B2/IN GTA-FR-C-B2/IS STA-C-B2/IC STA-C-B2/IN STA-C-B2/IS	GTA-C-B3/IC GTA-C-B3/IN GTA-C-B3/IS GTA-FR-C-B3/IC GTA-FR-C-B3/IN GTA-FR-C-B3/IS STA-C-B3/IC STA-C-B3/IN STA-C-B3/IS	GTA-N-B2/IN GTA-N-B2/IS GTA-N-U2/IN GTA-N-U2/IS GTA-FR-N-B2/IN GTA-FR-N-B2/IS GTA-FR-N-U2/IN GTA-FR-N-U2/IS STA-N-B2/IN STA-N-B2/IS	GTA-N-B3/IN GTA-N-B3/IS GTA-N-U3/IN GTA-N-U3/IS GTA-FR-N-B3/IN GTA-FR-N-B3/IS GTA-FR-N-U3/IN GTA-FR-N-U3/IS STA-N-B3/IN STA-N-B3/IS STA-N-U3/IN STA-N-U3/IS	GTA-N-B2 GTA-N-U2 GTA-FR-N-B2 GTA-FR-N-U2 STA-N-B2	GTA-N-B3 GTA-N-U3 GTA-FR-N-B3 GTA-FR-N-U3 STA-N-B3 STA-N-U3

# WARRANTY DURATION MATRIX

Roll goods listed under Base, Interply or Cap columns and separated by a comma are options for system configurations within each respective warranty duration row; these are not intended to be installed together or additively.

## APP SYSTEMS WITH BASE SHEET ADHERED

Warranty Duration	Warranty Fee (100 Sq Min)	Insulation/Coverboard	Base	Interply <sup>5</sup>	Cap	Applicable Specs	Notes
12 years	\$4.00/Sq	Optional <sup>1</sup>	Glasbase™ Base Sheet, Yosemite® Venting Base Sheet	—	Flintlastic GTA, Flintlastic GTA-FR, Flintlastic STA <sup>3</sup> , Flintlastic STA Plus	APP-C-2-T, APP-I-2-T	APP-I-2-T Approved for re-cover
15 years	\$7.50/Sq	Optional <sup>1</sup>	Flintlastic APP Base T, Black Diamond® Base Sheet	Optional	Flintlastic GTA, Flintlastic GTA-FR, Flintlastic STA <sup>4</sup> , Flintlastic STA Plus <sup>4</sup>	APP-C-2-T, APP-I-2-T	—
15 years	\$7.50/Sq	Optional <sup>2</sup>	Flintglas® Ply 4	Flintglas Ply 4	Flintlastic GTA, Flintlastic GTA-FR, Flintlastic STA <sup>4</sup> , Flintlastic STA Plus <sup>4</sup>	APP-C-3-T, APP-I-3-T	—
20 years	\$12.50/Sq	Double layer, second layer adhered	Flintlastic APP Base T, Black Diamond Base Sheet	Optional	Flintlastic GTA, Flintlastic GTA-FR, Flintlastic STA <sup>4</sup> , Flintlastic STA Plus <sup>4</sup>	APP-I-2-T	—
20 years	\$12.50/Sq	Optional <sup>1</sup>	Flintlastic Ultra Glass SA, Flintlastic STA	Optional	Flintlastic GTA, Flintlastic GTA-FR, Flintlastic STA <sup>4</sup> , Flintlastic STA Plus <sup>4</sup>	APP-C-2-T, APP-I-2-T	—
20 years	\$12.50/Sq	Optional <sup>2</sup>	Flintlastic APP Base T	Flintlastic APP Base T	Flintlastic GTA, Flintlastic GTA-FR, Flintlastic STA <sup>4</sup> , Flintlastic STA Plus <sup>4</sup>	APP-C-3-T, APP-I-3-T	—
20 years	\$12.50/Sq	Double layer, second layer adhered	Flintglas Premium Ply 6	Flintglas Premium Ply 6	Flintlastic GTA, Flintlastic GTA-FR, Flintlastic STA <sup>4</sup> , Flintlastic STA Plus <sup>4</sup>	APP-I-3-T	—
25 years	\$15.00/Sq	Optional <sup>2</sup>	All Weather/Empire Base, Flintlastic Poly SMS, Black Diamond Base Sheet	Flintlastic STA Plus	Flintlastic GTA, Flintlastic GTA-FR, Flintlastic STA Plus <sup>4</sup>	APP-C-3-T, APP-I-3-T	—
25 years	\$15.00/Sq	Double layer, second layer adhered	Flintlastic Ultra Glass SA, Flintlastic Ultra Poly SMS	Optional	Flintlastic GTA, Flintlastic GTA-FR, Flintlastic STA Plus <sup>4</sup>	APP-I-2-T	—
25 years	\$15.00/Sq	Double layer, second layer adhered	Black Diamond Base Sheet, Flintlastic Ultra Glass SA	Flintlastic STA	Flintlastic GTA, Flintlastic GTA-FR, Flintlastic STA Plus <sup>4</sup>	APP-I-3-T	—

Notes: Unless noted, prior approval required by CT Tech Services for re-cover.

1. If "Optional" Insulation/Coverboard is utilized, refer to "APP-I-2-T"\*

2. If "Optional" Insulation/Coverboard is utilized, refer to "APP-I-3-T"\*

3. Requires coating of FlintCoat® A300 or FlintCoat W.

4. Requires coating of FlintCoat A300 or FlintCoat W; proof of recoat required in year 10 and 20.

5. If "Optional" interply is utilized, ply number in specification ID increases by one (i.e APP-I-2-T becomes APP-I-3-T).

# WARRANTY DURATION MATRIX

Roll goods listed under Base, Interply or Cap columns and separated by a comma are options for system configurations within each respective warranty duration row; these are not intended to be installed together or additively.

## APP SYSTEMS WITH MECHANICALLY ATTACHED BASE SHEET

Warranty Duration	Warranty Fee (100 Sq Min)	Insulation/Coverboard	Base	Interply	Cap	Applicable Specs	Notes
12 years	\$4.00/Sq	Optional <sup>1</sup>	Glasbase™ Base Sheet, All Weather/Empire® Base Sheet, Flintlastic APP Base T, Yosemite® Venting Base Sheet	—	Flintlastic GTA, Flintlastic GTA-FR, Flintlastic STA <sup>3</sup> , Flintlastic STA Plus	APP-IN-2-T, APP-N-2-T	Approved for re-cover
15 years	\$7.50/Sq	Optional <sup>2</sup>	Glasbase Base Sheet, All Weather/Empire Base Sheet, Flintlastic APP Base T, Yosemite Venting Base Sheet	Flintlastic APP Base T, Black Diamond® Base Sheet	Flintlastic GTA, Flintlastic GTA-FR, Flintlastic STA <sup>3</sup> , Flintlastic STA Plus <sup>3</sup>	APP-IN-3-T, APP-N-3-T	—
20 years	\$12.50/Sq	Optional <sup>2</sup>	Glasbase Base Sheet, All Weather/Empire Base Sheet, Flintlastic APP Base T, Flintlastic Base 20, Yosemite Venting Base Sheet	Flintlastic Ultra Glass SA, Black Diamond® Base Sheet	Flintlastic GTA, Flintlastic GTA-FR, Flintlastic STA <sup>4</sup> , Flintlastic STA Plus <sup>4</sup>	APP-IN-3-T, APP-N-3-T	—
20 years	\$12.50/Sq	Single layer, minimum 1.5"	Glasbase Base Sheet, All Weather/Empire Base Sheet, Flintlastic Base 20, Flintlastic Poly SMS, Yosemite Venting Base Sheet	Flintlastic STA, Flintlastic Ultra Poly SMS, Black Diamond® Base Sheet	Flintlastic GTA, Flintlastic GTA-FR, Flintlastic STA <sup>4</sup> , Flintlastic STA Plus <sup>4</sup>	APP-N-3-T	—
20 years	\$12.50/Sq	Single layer, minimum 1.5" and approved coverboard	CertaFast system with Flintlastic Ultra Poly SMS	—	Flintlastic GTA, Flintlastic GTA-FR, Flintlastic STA Plus <sup>4</sup>	APP-IN-2-CF	—
25 years	\$15.00/Sq	Optional <sup>2</sup>	All Weather/Empire Base Sheet, Flintlastic Base 20, Flintlastic Poly SMS, Yosemite Venting Base Sheet	Flintlastic STA Plus	Flintlastic GTA, Flintlastic GTA-FR, Flintlastic STA Plus <sup>4</sup>	APP-IN-3-T, APP-N-3-T	—
25 years	\$15.00/Sq	Single layer, minimum 1.5"	All Weather/Empire Base Sheet, Flintlastic Base 20, Flintlastic Poly SMS	Flintlastic Ultra Glass SA, Flintlastic Ultra Poly SMS	Flintlastic GTA, Flintlastic GTA-FR, Flintlastic STA Plus <sup>4</sup>	APP-IN-3-T	—

Notes: Unless noted, prior approval required by CT Tech Services for re-cover.

Yosemite Venting Base Sheet may be appropriate over Lightweight Insulating Concrete or in re-cover applications.

1. If "Optional" Insulation/Coverboard is utilized, refer to "APP-IN-2-T"\*
2. If "Optional" Insulation/Coverboard is utilized, refer to "APP-IN-3-T"\*
3. Requires coating of FlintCoat® A300 or FlintCoat W.
4. Requires coating of FlintCoat A300 or FlintCoat W; proof of recoat required in year 10 and 20.

# APP-C-2-T

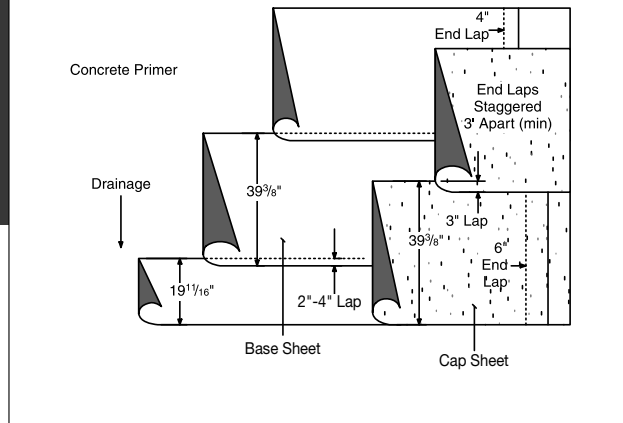

## Adhered base sheet and torch-welded APP modified cap sheet

### SUBSTRATE:

- Non-nailable; concrete (Sec. 3.6)

### MAXIMUM SLOPE:

Up to 6" : 12" (Sec. 15.3)

### ROOF ASSEMBLY:

Approved base sheet set in hot asphalt (Sec. 7.0), torch-welded (Sec. 8.0) or self-adhered (Sec. 10.2).

Approved cap sheet, torch-welded (Sec. 8.0).

### SUMMARY OF MATERIALS:

- FlintPrime® asphalt primer
- Base sheet (1 ply)
- Cap sheet (1 ply)
- ASTM D 312 asphalt (one mopping)  
(No moppings if base is torch-welded or self-adhered)

### APPROVED BASE SHEETS:

(one of the following)

#### Hot Asphalt Applied

- All Weather/Empire® Base Sheet
- Flexiglas® Base Sheet
- Flintlastic Base 20
- Flintlastic Poly SMS
- Flintlastic Ultra Poly SMS
- Glasbase™ Base Sheet
- Yosemite® Venting Base Sheet

### Torch Welded

- APP Base T
- Flintlastic STA
- Flintlastic STA Plus
- Flintlastic Ultra Poly SMS

### Self-Adhered

- Black Diamond® Base Sheet
- Flintlastic Ultra Glass SA

### APPROVED CAP SHEETS:

(one of the following)

- Flintlastic GTA\*
- Flintlastic GTA-FR\*
- Flintlastic STA
- Flintlastic STA Plus

### FINAL SURFACING:

For optional surfacing see Section 14.0.

Flintlastic STA and STA Plus (used as cap sheets) require reflective coating.

### FLASHING ASSEMBLY:

- **Standard.** Over a base sheet or bonded to a primed substrate. Oneply Flintlastic modified cap sheet, per CT detail.
- **Premium.** Over a base sheet or bonded to a primed substrate. One smooth and one granulated modified membrane flashing, per CT detail.
- **Premium Alternate.** Over a base sheet or bonded to a primed substrate. One smooth modified membrane and CT SmartFlash®, per CT detail.

### FINAL SURFACING:

- FlintCoat A300 or W (required over Flintlastic STA and STA Plus)

**Asphalt:** Type III or Type IV (Sec. 7.0).

**Cants:** In angles of roof deck and vertical surfaces, the roofing contractor shall furnish and install an approved cant strip with a minimum 3" face.

\* Available with CoolStar® reflective granules

WARRANTY DURATIONS FOR THIS SPECIFICATION VARY BASED ON ROLL MATERIAL SELECTION; SEE WARRANTY MATRIX.

Applicable local building code may require more stringent installation requirements such as, but not limited to, increased fastener or adhesive densities to meet required wind uplift pressures. Consult local building code and uplift requirements prior to any application of CertainTeed roofing materials. CertainTeed is not responsible for failure to install roofing products per applicable local building codes.

Consult CertainTeed General Recommendations for noted section references.

**CertainTeed**  
SAINT-GOBAIN  
Commercial Roofing

# APP-C-3-T

## Adhered base sheet, adhered interply sheet and torch-welded APP modified cap sheet

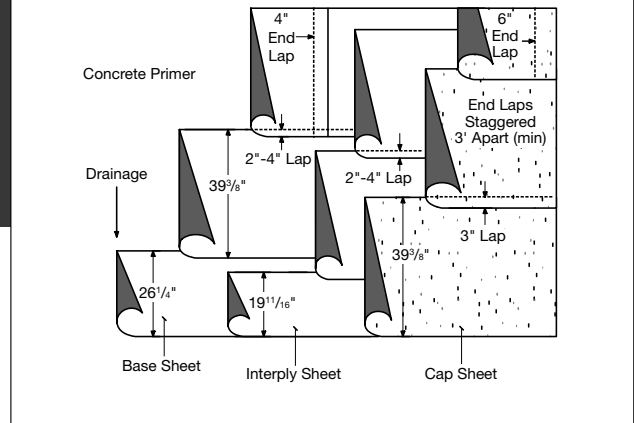

### SUBSTRATE:

- Non-nailable; concrete (Sec. 3.6)

### MAXIMUM SLOPE:

Up to 6" : 12" (Sec. 15.3)

### ROOF ASSEMBLY:

Approved base sheet, set in hot asphalt (Sec. 7.0), torch-welded (Sec. 8.0) or self-adhered (Sec. 10.2).

Approved Interply sheet set in hot asphalt (Sec. 7.0), torch-welded (Sec. 8.0) or self-adhered (Sec. 10.2).

Approved cap sheet, torch-welded (Sec. 8.0).

### SUMMARY OF MATERIALS:

- FlintPrime® asphalt primer
- Base sheet (1 ply)
- Interply sheet (1 ply)
- Cap sheet (1 ply)
- ASTM D 312 asphalt (two moppings)  
(No moppings if base and ply are torch-welded or self-adhered)

### APPROVED BASE SHEETS:

(one of the following)

#### Hot Asphalt Applied

- All Weather/Empire® Base Sheet
- Flexiglas® Base Sheet
- Flintglas® Ply 4
- Flintglas Premium Ply 6
- Flintlastic Base 20
- Flintlastic Poly SMS
- Flintlastic Ultra Poly SMS
- Glasbase™ Base Sheet
- Yosemite® Venting Base Sheet

#### Torch Welded

- APP Base T
- Flintlastic STA

- Flintlastic STA Plus
- Flintlastic Ultra Poly SMS

### Self-Adhered

- Black Diamond® Base Sheet
- Flintlastic Ultra Glass SA

### APPROVED INTERPLY SHEETS:

(one of the following)

#### Hot Asphalt Applied

- All Weather/Empire Base Sheet
- Flexiglas Base Sheet
- Flintglas Ply 4
- Flintglas Premium Ply 6
- Flintlastic Base 20
- Flintlastic Poly SMS
- Flintlastic Ultra Poly SMS
- Glasbase Base Sheet
- Yosemite Venting Base Sheet

#### Torch Welded

- APP Base T
- Flintlastic STA
- Flintlastic STA Plus
- Flintlastic Ultra Poly SMS

### Self-Adhered

- Black Diamond Base Sheet\*\*
- Flintlastic Ultra Glass SA\*\*

### APPROVED CAP SHEETS:

(one of the following)

- Flintlastic GTA\*
- Flintlastic GTA-FR\*
- Flintlastic STA
- Flintlastic STA Plus

### FINAL SURFACING:

For optional surfacing see Section 14.0.

Flintlastic STA and STA Plus (used as cap sheets) require reflective coating.

- FlintCoat A300 or W (required over Flintlastic STA and STA Plus)

### FLASHING ASSEMBLY:

- **Standard.** Over a base sheet or bonded to a primed substrate. One ply Flintlastic modified cap sheet, per CT detail.
- **Premium.** Over a base sheet or bonded to a primed substrate. One smooth and one granulated modified membrane flashing, per CT detail.
- **Premium Alternate.** Over a base sheet or bonded to a primed substrate. One smooth modified membrane and CT SmartFlash®, per CT detail.

**Asphalt:** Type III or Type IV (Sec. 7.0).

**Cants:** In angles of roof deck and vertical surfaces, the roofing contractor shall furnish and install an approved cant strip with a minimum 3" face.

\* Available with CoolStar® reflective granules

\*\* Not approved over APP Base T, Flintlastic STA or Flintlastic STA Plus

WARRANTY DURATIONS FOR THIS SPECIFICATION VARY BASED ON ROLL MATERIAL SELECTION; SEE WARRANTY MATRIX.

Applicable local building code may require more stringent installation requirements such as, but not limited to, increased fastener or adhesive densities to meet required wind uplift pressures. Consult local building code and uplift requirements prior to any application of CertainTeed roofing materials. CertainTeed is not responsible for failure to install roofing products per applicable local building codes.

# APP-C-4-T

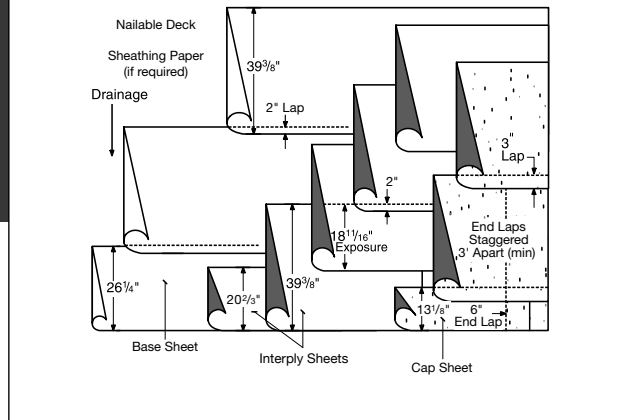

## Adhered base sheet, two adhered interply sheets and torch-welded APP modified cap sheet

### SUBSTRATE:

- Non-nailable; concrete (Sec. 3.6)

### MAXIMUM SLOPE:

Up to 6" : 12" (Sec. 15.3)

### ROOF ASSEMBLY:

Approved base sheet, set in hot asphalt (Sec. 7.0), torch-welded (Sec. 8.0) or self-adhered (Sec. 10.2).

Two approved interply sheets set in hot asphalt (Sec. 7.0), torch-welded (Sec. 8.0) or self-adhered (Sec. 10.2).

Approved cap sheet, torch-welded (Sec. 8.0).

### SUMMARY OF MATERIALS:

- FlintPrime® asphalt primer
- Base sheet (1 ply)
- Interply sheet (2 plies)
- Cap sheet (1 ply)
- ASTM D 312 asphalt (three moppings)  
(No moppings if base is torch-welded or self-adhered)

### APPROVED BASE SHEETS:

(one of the following)

#### Hot Asphalt Applied

- All Weather/Empire® Base Sheet
- Flexiglas® Base Sheet
- Flintlastic Base 20
- Flintlastic Poly SMS
- Flintlastic Ultra Poly SMS
- Glasbase™ Base Sheet

WARRANTY DURATIONS FOR THIS SPECIFICATION VARY BASED ON ROLL MATERIAL SELECTION; SEE WARRANTY MATRIX.

Applicable local building code may require more stringent installation requirements such as, but not limited to, increased fastener or adhesive densities to meet required wind uplift pressures. Consult local building code and uplift requirements prior to any application of CertainTeed roofing materials. CertainTeed is not responsible for failure to install roofing products per applicable local building codes.

- Yosemite® Venting Base Sheet

### Torch Welded

- APP Base T
- Flintlastic STA
- Flintlastic STA Plus
- Flintlastic Ultra Poly SMS

### Self-Adhered

- Black Diamond® Base Sheet\*\*
- Flintlastic Ultra Glass SA\*\*

### APPROVED INTERPLY SHEETS:

(two of the following)

#### Hot Asphalt Applied

- All Weather/Empire Base Sheet
- Flexiglas Base Sheet
- Flintglas Ply 4
- Flintglas Premium Ply 6
- Flintlastic Base 20
- Flintlastic Poly SMS
- Flintlastic Ultra Poly SMS
- Glasbase Base Sheet
- Yosemite Venting Base Sheet

### Torch Welded

- APP Base T
- Flintlastic STA
- Flintlastic STA Plus
- Flintlastic Ultra Poly SMS

### Self-Adhered

- Black Diamond Base Sheet\*\*
- Flintlastic Ultra Glass SA\*\*

### APPROVED CAP SHEETS:

(one of the following)

- Flintlastic GTA\*

- Flintlastic GTA-FR\*
- Flintlastic STA
- Flintlastic STA Plus

### FINAL SURFACING:

For optional surfacing see Section 14.0.

Flintlastic STA and STA Plus (used as cap sheets) require reflective coating.

- FlintCoat A300 or W (required over Flintlastic STA and STA Plus)

### FLASHING ASSEMBLY:

- **Standard.** Over a base sheet or bonded to a primed substrate. Oneply Flintlastic modified cap sheet, per CT detail.
- **Premium.** Over a base sheet or bonded to a primed substrate. One smooth and one granulated modified membrane flashing, per CT detail.
- **Premium Alternate.** Over a base sheet or bonded to a primed substrate. One smooth modified membrane and CT SmartFlash®, per CT detail.

**Asphalt:** Type III or Type IV (Sec. 7.0).

**Cants:** In angles of roof deck and vertical surfaces, the roofing contractor shall furnish and install an approved cant strip with a minimum 3" face.

\* Available with CoolStar® reflective granules

\*\* Not approved over APP Base T, Flintlastic STA or Flintlastic STA Plus

Consult CertainTeed General Recommendations for noted section references.

# APP-I-2-T

## Insulated substrates: adhered base sheet and torch-welded APP modified cap sheet

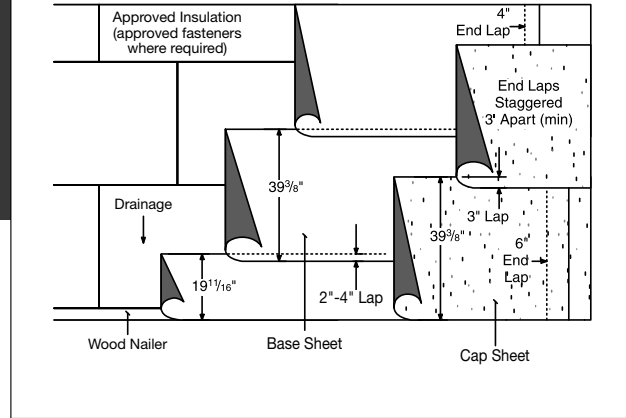

### SUBSTRATE:

- Non-nailable; concrete (Sec. 3.6)
- Re-cover (Sec. 5.0)

### MAXIMUM SLOPE:

Up to 6" : 12" (Sec. 15.3)

### ROOF ASSEMBLY:

One or more layers of approved insulation and/or coverboard:

- Base layer mechanically attached and additional layers mechanically attached or adhered in hot asphalt or approved adhesive.
- Base layer and additional layers adhered in hot asphalt or approved adhesive.
- Vapor retarder/anchor sheets (Sec. 4.7).

Approved base sheet set in hot asphalt (Sec. 7.0), torch-welded (Sec. 8.0), or self-adhered (Sec. 10.2).

Approved cap sheet, torch-welded (Sec. 8.0).

### SUMMARY OF MATERIALS:

- One or more layers of insulation and/or coverboard.
- Base sheet (1 ply)
- Cap sheet (1 ply)
- ASTM D 312 asphalt (one mopping)  
(No moppings if base is torch-welded or self-adhered)

### APPROVED BASE SHEETS:

(one of the following)

#### Hot Asphalt Applied

- All Weather/Empire® Base Sheet

- Flexiglas® Base Sheet
- Flintlastic Base 20
- Flintlastic Poly SMS
- Flintlastic Ultra Poly SMS
- Glasbase™ Base Sheet
- Yosemite® Venting Base Sheet

### TORCH WELDED

(over approved products)

- APP Base T\*\*
- Flintlastic STA\*\*
- Flintlastic STA Plus\*\*
- Flintlastic Ultra Poly SMS\*\*

### Self-Adhered

- Black Diamond® Base Sheet
- Flintlastic Ultra Glass SA

### APPROVED CAP SHEETS:

(one of the following)

- Flintlastic GTA\*
- Flintlastic GTA-FR\*
- Flintlastic STA
- Flintlastic STA Plus

### FINAL SURFACING:

For optional surfacing see Section 14.0.

Flintlastic STA and STA Plus (used as cap sheets) require reflective coating.

- FlintCoat A300 or W (required over Flintlastic STA and STA Plus)

### FLASHING ASSEMBLY:

- **Standard.** Over a base sheet or bonded to a primed substrate. One ply Flintlastic modified cap sheet, per CT detail.
- **Premium.** Over a base sheet or bonded to a primed substrate. One smooth and one granulated modified membrane flashing, per CT detail.
- **Premium Alternate.** Over a base sheet or bonded to a primed substrate. One smooth modified membrane and CT SmartFlash®, per CT detail.

**Asphalt:** Type III or Type IV (Sec. 7.0).

**Cants:** In angles of roof deck and vertical surfaces, the roofing contractor shall furnish and install an approved cant strip with a minimum 3" face.

\* Available with CoolStar® reflective granules

\*\* Approved gypsum coverboards only

WARRANTY DURATIONS FOR THIS SPECIFICATION VARY BASED ON ROLL MATERIAL SELECTION; SEE WARRANTY MATRIX.

Applicable local building code may require more stringent installation requirements such as, but not limited to, increased fastener or adhesive densities to meet required wind uplift pressures. Consult local building code and uplift requirements prior to any application of CertainTeed roofing materials. CertainTeed is not responsible for failure to install roofing products per applicable local building codes.



# APP-I-3-T

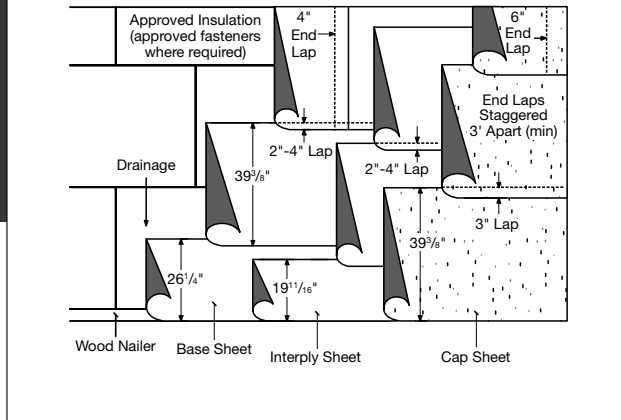

## Insulated substrates: adhered base sheet, adhered interply sheet and torch-welded APP modified cap sheet

### SUBSTRATE:

- Non-nailable; concrete (Sec. 3.6)
- Re-cover (Sec. 5.0)

### MAXIMUM SLOPE:

Up to 6": 12" (Sec. 15.3)

### ROOF ASSEMBLY:

One or more layers of approved insulation and/or coverboard:

- Base layer mechanically attached and additional layers mechanically attached or adhered in hot asphalt or approved adhesive.
- Base layer and additional layers adhered in hot asphalt or approved adhesive.
- Vapor retarder/anchor sheets (Sec. 4.7).

Approved base sheet set in hot asphalt (Sec. 7.0), torch-welded (Sec. 8.0), or self-adhered (Sec. 10.2).

Approved interply sheet set in hot asphalt (Sec. 7.0), torch-welded (Sec. 8.0), or self-adhered (Sec. 10.2).

Approved cap sheet, torch-welded (Sec. 8.0).

### SUMMARY OF MATERIALS:

- One or more layers of insulation and/ or coverboard.
- Base sheet (1 ply)
- Interply sheet (1 ply)
- Cap sheet (1 ply)
- ASTM D 312 asphalt (two moppings) (No moppings if base is torch-welded or self-adhered)

WARRANTY DURATIONS FOR THIS SPECIFICATION VARY BASED ON ROLL MATERIAL SELECTION; SEE WARRANTY MATRIX.

Applicable local building code may require more stringent installation requirements such as, but not limited to, increased fastener or adhesive densities to meet required wind uplift pressures. Consult local building code and uplift requirements prior to any application of CertainTeed roofing materials. CertainTeed is not responsible for failure to install roofing products per applicable local building codes.

### APPROVED BASE SHEETS:

(one of the following)

#### Hot Asphalt Applied

- All Weather/Empire® Base Sheet
- Flexiglas® Base Sheet
- Flintlastic Base 20
- Flintlastic Poly SMS
- Flintlastic Ultra Poly SMS
- Glasbase™ Base Sheet
- Yosemite® Venting Base Sheet

#### Torch Welded

- APP Base T\*\*
- Flintlastic STA\*\*
- Flintlastic STA Plus\*\*
- Flintlastic Ultra Poly SMS\*\*

#### Self-Adhered

- Black Diamond® Base Sheet
- Flintlastic Ultra Glass SA

### APPROVED INTERPLY SHEETS:

(One of the following)

#### Hot Asphalt Applied

- All Weather/Empire Base Sheet
- Flexiglas Base Sheet
- Flintglas Ply 4
- Flintglas Premium Ply 6
- Flintlastic Base 20
- Flintlastic Poly SMS
- Flintlastic Ultra Poly SMS
- Glasbase Base Sheet
- Yosemite Venting Base Sheet

#### Torch Welded

- APP Base T
- Flintlastic STA
- Flintlastic STA Plus
- Flintlastic Ultra Poly SMS

### Self-Adhered

- Black Diamond Base Sheet\*\*\*
- Flintlastic Ultra Glass SA\*\*\*

### APPROVED CAP SHEETS:

(one of the following)

- Flintlastic GTA\*
- Flintlastic GTA-FR\*
- Flintlastic STA
- Flintlastic STA Plus

### FINAL SURFACING:

For optional surfacing see Section 14.0.

Flintlastic STA and STA Plus (used as cap sheets) require reflective coating.

- FlintCoat A300 or W (required over Flintlastic STA and STA Plus)

### FLASHING ASSEMBLY:

- **Standard.** Over a base sheet or bonded to a primed substrate. One ply Flintlastic modified cap sheet, per CT detail.
- **Premium.** Over a base sheet or bonded to a primed substrate. One smooth and one granulated modified membrane flashing, per CT detail.
- **Premium Alternate.** Over a base sheet or bonded to a primed substrate. One smooth modified membrane and CT SmartFlash®, per CT detail.

**Asphalt:** Type III or Type IV (Sec. 7.0).

**Cants:** In angles of roof deck and vertical surfaces, the roofing contractor shall furnish and install an approved cant strip with a minimum 3" face.

\* Available with CoolStar® reflective granules

\*\* Approved gypsum coverboards only

\*\*\* Not approved over APP Base T, Flintlastic STA or Flintlastic STA Plus

# APP-I-4-T

## Insulated substrates: adhered base sheet, two adhered interply sheets and torch-welded APP modified cap sheet

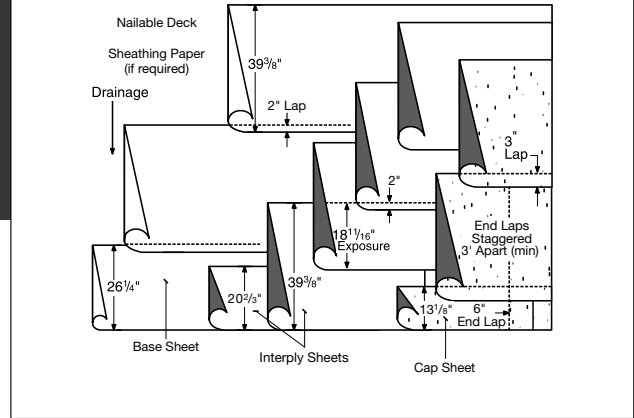

### SUBSTRATE:

- Non-nailable; concrete (Sec. 3.6)
- Re-cover (Sec. 5.0)

### MAXIMUM SLOPE:

Up to 6" : 12" (Sec. 15.3)

### ROOF ASSEMBLY:

One or more layers of approved insulation and/or coverboard:

- Base layer mechanically attached and additional layers mechanically attached or adhered in hot asphalt or approved adhesive.
- Base layer and additional layers adhered in hot asphalt or approved adhesive.
- Vapor retarder/anchor sheets (Sec. 4.7). Approved base sheet set in hot asphalt (Sec. 7.0), torch-welded (Sec. 8.0), or self-adhered (Sec. 10.2).
- Two approved interply sheets set in hot asphalt (Sec. 7.0), torch-welded (Sec. 8.0), or self-adhered (Sec. 10.2).
- Approved cap sheet, torch-welded (Sec. 8.0).

### SUMMARY OF MATERIALS:

- One or more layers of insulation and/ or coverboard.
- Base sheet (1 ply)
- Interply sheets (2 ply)
- Cap sheet (1 ply)
- ASTM D 312 asphalt (three moppings) (No moppings if base is torch-welded or self-adhered)

### APPROVED BASE SHEETS:

(Two of the following)

#### Hot Asphalt Applied

- All Weather/Empire® Base Sheet
- Flexiglas® Base Sheet
- Flintlastic Base 20

- Flintlastic Poly SMS
- Flintlastic Ultra Poly SMS
- Glasbase™ Base Sheet
- Yosemite® Venting Base Sheet

#### Torch Welded

- APP Base T\*\*
- Flintlastic STA\*\*
- Flintlastic STA Plus\*\*
- Flintlastic Ultra Poly SMS\*\*

#### Self-Adhered

- Black Diamond® Base Sheet
- Flintlastic Ultra Glass SA

### APPROVED INTERPLY SHEETS:

(One of the following)

#### Hot Asphalt Applied

- All Weather/Empire Base Sheet
- Flexiglas Base Sheet
- Flintglas Ply 4
- Flintglas Premium Ply 6
- Flintlastic Base 20
- Flintlastic Poly SMS
- Flintlastic Ultra Poly SMS
- Glasbase Base Sheet
- Yosemite Venting Base Sheet

#### Torch Welded

- APP Base T
- Flintlastic STA
- Flintlastic STA Plus
- Flintlastic Ultra Poly SMS

#### Self-Adhered

- Black Diamond Base Sheet\*\*
- Flintlastic Ultra Glass SA\*\*

### APPROVED CAP SHEETS:

(one of the following)

- Flintlastic GTA\*
- Flintlastic GTA-FR\*
- Flintlastic STA
- Flintlastic STA Plus

### FINAL SURFACING:

For optional surfacing see Section 14.0.

Flintlastic STA and STA Plus (used as cap sheets) require reflective coating.

- FlintCoat A300 or W (required over Flintlastic STA and STA Plus)

### FLASHING ASSEMBLY:

- **Standard.** Over a base sheet or bonded to a primed substrate. One ply Flintlastic modified cap sheet, per CT detail.
- **Premium.** Over a base sheet or bonded to a primed substrate. One smooth and one granulated modified membrane flashing, per CT detail.
- **Premium Alternate.** Over a base sheet or bonded to a primed substrate. One smooth modified membrane and CT SmartFlash®, per CT detail.

**Asphalt:** Type III or Type IV (Sec. 7.0).

**Cants:** In angles of roof deck and vertical surfaces, the roofing contractor shall furnish and install an approved cant strip with a minimum 3" face.

\* Available with CoolStar® reflective granules

WARRANTY DURATIONS FOR THIS SPECIFICATION VARY BASED ON ROLL MATERIAL SELECTION; SEE WARRANTY MATRIX.

Applicable local building code may require more stringent installation requirements such as, but not limited to, increased fastener or adhesive densities to meet required wind uplift pressures. Consult local building code and uplift requirements prior to any application of CertainTeed roofing materials. CertainTeed is not responsible for failure to install roofing products per applicable local building codes.

**CertainTeed**  
SAINT-GOBAIN

Commercial Roofing

Consult CertainTeed General Recommendations for noted section references.

# APP-IN-2-T

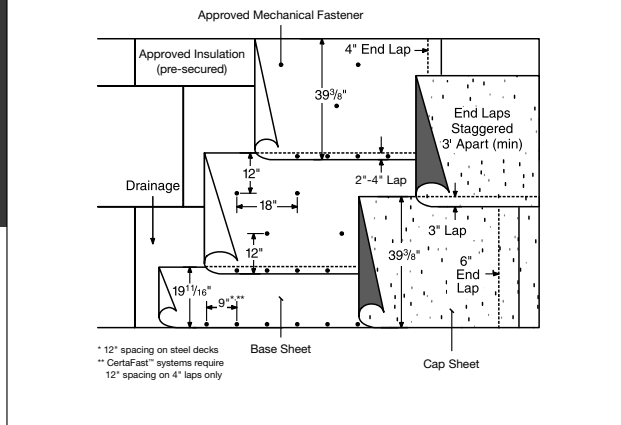

## Base sheet mechanically attached through insulated substrate and torch-welded APP modified cap

### SUBSTRATE:

- Non-nailable; concrete (Sec. 3.6)
- Re-cover (Sec. 5.0)

### MAXIMUM SLOPE:

Up to 6" : 12" (Sec. 15.3)

### ROOF ASSEMBLY:

One or more layers of approved insulation and/or coverboard:

- Insulation pre-secured with mechanical attachment.

Approved base sheet mechanically attached with approved screws and plates (Sec. 15.4.2).

Approved cap sheet, torch-welded (Sec. 8.0).

### SUMMARY OF MATERIALS:

- One or more layers of Insulation and/ or coverboard
- Base sheet (1 ply)
- Cap sheet (1 ply)

### APPROVED BASE SHEETS:

(one of the following)

- All Weather/Empire® Base Sheet
- Flexiglas® Base Sheet
- Flintlastic Base 20
- Flintlastic Poly SMS
- Flintlastic Ultra Poly SMS
- Glasbase™ Base Sheet
- Yosemite® Venting Base Sheet
- Flintlastic APP Base T

### APPROVED CAP SHEETS:

(one of the following)

- Flintlastic GTA\*
- Flintlastic GTA-FR\*
- Flintlastic STA
- Flintlastic STA Plus

### FINAL SURFACING:

For optional surfacing see Section 14.0.

Flintlastic STA and STA Plus (used as cap sheets) require reflective coating.

- FlintCoat A300 or W (required over Flintlastic STA and STA Plus)

### FLASHING ASSEMBLY:

- **Standard.** Over a base sheet or bonded to a primed substrate. One ply Flintlastic modified cap sheet, per CT detail.
- **Premium.** Over a base sheet or bonded to a primed substrate. One smooth and one granulated modified membrane flashing, per CT detail.
- **Premium Alternate.** Over a base sheet or bonded to a primed substrate. One smooth modified membrane and CT SmartFlash®, per CT detail.

**Cants:** In angles of roof deck and vertical surfaces, the roofing contractor shall furnish and install an approved cant strip with a minimum 3" face.

\* Available with CoolStar® reflective granules

WARRANTY DURATIONS FOR THIS SPECIFICATION VARY BASED ON ROLL MATERIAL SELECTION; SEE WARRANTY MATRIX.

Applicable local building code may require more stringent installation requirements such as, but not limited to, increased fastener or adhesive densities to meet required wind uplift pressures. Consult local building code and uplift requirements prior to any application of CertainTeed roofing materials. CertainTeed is not responsible for failure to install roofing products per applicable local building codes.

Consult CertainTeed General Recommendations for noted section references.

**CertainTeed**  
SAINT-GOBAIN  
Commercial Roofing

# APP-IN-3-T

## Base sheet mechanically attached through insulated substrate, adhered interply sheet and torch-welded APP modified cap

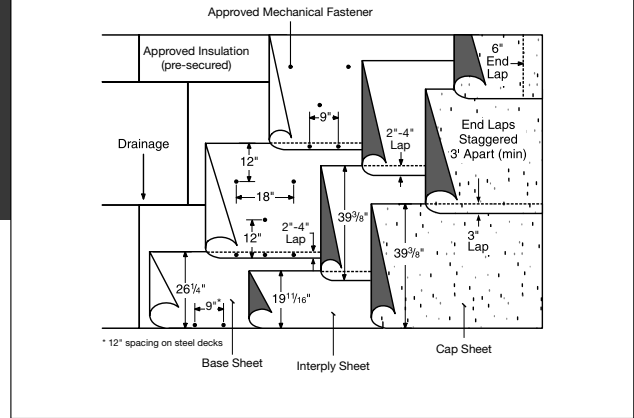

### SUBSTRATE:

- Non-nailable; concrete (Sec. 3.6)
- Re-cover (Sec. 5.0)

### MAXIMUM SLOPE:

Up to 6" : 12" (Sec. 15.3)

### ROOF ASSEMBLY:

One or more layers of approved insulation and/or coverboard:

- Insulation pre-secured with mechanical attachment.

Approved base sheet mechanically attached with approved screws and plates (Sec. 15.4.2).

Approved interply sheet set in hot asphalt (Sec. 7.0), torch-welded (Sec. 8.0) or self-adhered (Sec. 10.2).

Approved cap sheet, torch-welded (Sec. 8.0).

### SUMMARY OF MATERIALS:

- One or more layers of Insulation and/or coverboard
- Base sheet (1 ply)
- Interply sheet (1 ply)
- Cap sheet (1 ply)
- ASTM D 312 asphalt (1 mopping)  
(no mopping if interply torch-welded or self-adhered)

### APPROVED BASE SHEETS:

(one of the following)

- All Weather/Empire® Base Sheet
- Flexiglas® Base Sheet
- Flintlastic Base 20
- Flintlastic Poly SMS
- Flintlastic Ultra Poly SMS
- Glasbase™ Base Sheet
- Yosemite® Venting Base Sheet
- Flintlastic APP Base T

### APPROVED INTERPLY SHEETS:

(One of the following)

#### Hot Asphalt Applied

- All Weather/Empire Base Sheet
- Flexiglas Base Sheet
- Flintglas Ply 4
- Flintglas Premium Ply 6
- Flintlastic Base 20
- Flintlastic Poly SMS
- Flintlastic Ultra Poly SMS
- Glasbase Base Sheet
- Yosemite Venting Base Sheet

#### Torch Welded

- APP Base T
- Flintlastic STA
- Flintlastic STA Plus
- Flintlastic Ultra Poly SMS

#### Self-Adhered

- Black Diamond Base Sheet\*\*
- Flintlastic Ultra Glass SA\*\*

### APPROVED CAP SHEETS:

(one of the following)

- Flintlastic GTA\*
- Flintlastic GTA-FR\*
- Flintlastic STA
- Flintlastic STA Plus

### FINAL SURFACING:

For optional surfacing see Section 14.0.

Flintlastic STA and STA Plus (used as cap sheets) require reflective coating.

- FlintCoat A300 or W (required over Flintlastic STA and STA Plus)

### FLASHING ASSEMBLY:

- **Standard.** Over a base sheet or bonded to a primed substrate. One ply Flintlastic modified cap sheet, per CT detail.
- **Premium.** Over a base sheet or bonded to a primed substrate. One smooth and one granulated modified membrane flashing, per CT detail.
- **Premium Alternate.** Over a base sheet or bonded to a primed substrate. One smooth modified membrane and CT SmartFlash®, per CT detail.

**Cants:** In angles of roof deck and vertical surfaces, the roofing contractor shall furnish and install an approved cant strip with a minimum 3" face.

\* Available with CoolStar® reflective granules

\*\* Not approved over APP Base T, Flintlastic STA or Flintlastic STA Plus

WARRANTY DURATIONS FOR THIS SPECIFICATION VARY BASED ON ROLL MATERIAL SELECTION; SEE WARRANTY MATRIX.

Applicable local building code may require more stringent installation requirements such as, but not limited to, increased fastener or adhesive densities to meet required wind uplift pressures. Consult local building code and uplift requirements prior to any application of CertainTeed roofing materials. CertainTeed is not responsible for failure to install roofing products per applicable local building codes.

# APP-IN-4-T

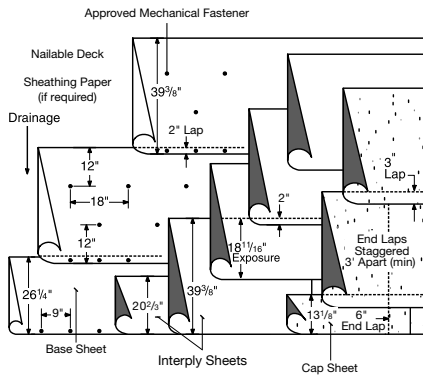

**Base sheet mechanically attached through insulated substrate, two adhered interply sheets and torch-welded APP modified cap**

## SUBSTRATE:

- Non-nailable; concrete (Sec. 3.6)
- Re-cover (Sec. 5.0)

## MAXIMUM SLOPE:

Up to 6" : 12" (Sec. 15.3)

## ROOF ASSEMBLY:

One or more layers of approved insulation and/or coverboard:

- Insulation pre-secured with mechanical attachment.

Approved base sheet mechanically attached with approved screws and plates (Sec. 15.4.2).

Two approved interply sheets set in hot asphalt (Sec. 7.0), torch-welded (Sec. 8.0) or self-adhered (Sec. 10.2).

Approved cap sheet, torch-welded (Sec. 8.0).

## SUMMARY OF MATERIALS:

- One or more layers of Insulation and/ or coverboard
- Base sheet (1 ply)
- Interply sheet (2 ply)
- Cap sheet (1 ply)
- ASTM D 312 asphalt (2 moppings) (no moppings if interply torch-welded or self-adhered)

## APPROVED BASE SHEETS:

(one of the following)

- All Weather/Empire® Base Sheet
- Flexiglas® Base Sheet

- Flintlastic Base 20
- Flintlastic Poly SMS
- Flintlastic Ultra Poly SMS
- Glasbase™ Base Sheet
- Yosemite® Venting Base Sheet
- Flintlastic APP Base T

## APPROVED INTERPLY SHEETS:

(Two of the following)

### Hot Asphalt Applied

- All Weather/Empire Base Sheet
- Flexiglas Base Sheet
- Flintglas Ply 4
- Flintglas Premium Ply 6
- Flintlastic Base 20
- Flintlastic Poly SMS
- Flintlastic Ultra Poly SMS
- Glasbase Base Sheet
- Yosemite Venting Base Sheet

### Torch Welded

- APP Base T
- Flintlastic STA
- Flintlastic STA Plus
- Flintlastic Ultra Poly SMS

### Self-Adhered

- Black Diamond Base Sheet\*\*
- Flintlastic Ultra Glass SA\*\*

## APPROVED CAP SHEETS:

(one of the following)

- Flintlastic GTA\*
- Flintlastic GTA-FR\*
- Flintlastic STA
- Flintlastic STA Plus

## FINAL SURFACING:

For optional surfacing see Section 14.0.

Flintlastic STA and STA Plus (used as cap sheets) require reflective coating.

- FlintCoat A300 or W (required over Flintlastic STA and STA Plus)

## FLASHING ASSEMBLY:

- **Standard.** Over a base sheet or bonded to a primed substrate. One ply Flintlastic modified cap sheet, per CT detail.
- **Premium.** Over a base sheet or bonded to a primed substrate. One smooth and one granulated modified membrane flashing, per CT detail.
- **Premium Alternate.** Over a base sheet or bonded to a primed substrate. One smooth modified membrane and CT SmartFlash®, per CT detail.

**Cants:** In angles of roof deck and vertical surfaces, the roofing contractor shall furnish and install an approved cant strip with a minimum 3" face.

\* Available with CoolStar® reflective granules

\*\* Not approved over APP Base T, Flintlastic STA or Flintlastic STA Plus

WARRANTY DURATIONS FOR THIS SPECIFICATION VARY BASED ON ROLL MATERIAL SELECTION; SEE WARRANTY MATRIX.

Applicable local building code may require more stringent installation requirements such as, but not limited to, increased fastener or adhesive densities to meet required wind uplift pressures. Consult local building code and uplift requirements prior to any application of CertainTeed roofing materials. CertainTeed is not responsible for failure to install roofing products per applicable local building codes.

Consult CertainTeed General Recommendations for noted section references.

**CertainTeed**  
SAINT-GOBAIN  
Commercial Roofing

# APP-N-2-T

## Base sheet mechanically attached through substrate and torch-welded APP modified cap

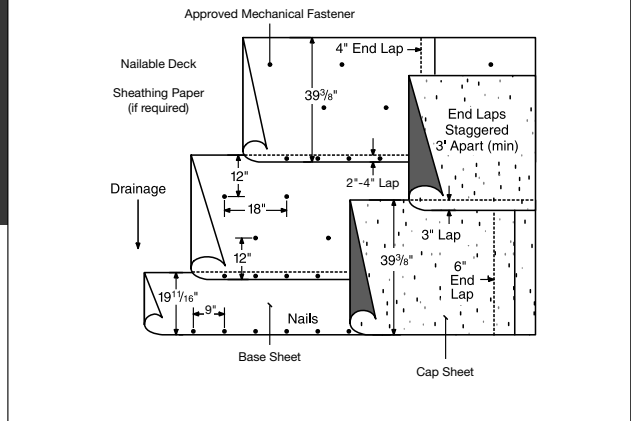

### SUBSTRATE:

- Non-nailable; concrete (Sec. 3.6)
- Re-cover (Sec. 5.0)

### MAXIMUM SLOPE:

Up to 6" : 12" (Sec. 15.3)

### ROOF ASSEMBLY:

Approved base sheet mechanically attached to approved substrate (Sec. 15.0)

Approved cap sheet, torch-welded (Sec. 8.0).

### SUMMARY OF MATERIALS:

- Base sheet (1 ply)
- Cap sheet (1 ply)

### APPROVED BASE SHEETS:

(one of the following)

- All Weather/Empire® Base Sheet
- Flexiglas® Base Sheet
- Flintlastic Base 20
- Flintlastic Poly SMS
- Flintlastic Ultra Poly SMS
- Glasbase™ Base Sheet
- Yosemite® Venting Base Sheet
- Flintlastic APP Base T

### APPROVED CAP SHEETS:

(one of the following)

- Flintlastic GTA\*
- Flintlastic GTA-FR\*
- Flintlastic STA
- Flintlastic STA Plus

### FINAL SURFACING:

For optional surfacing see Section 14.0.

Flintlastic STA and STA Plus (used as cap sheets) require reflective coating.

- FlintCoat A300 or W (required over Flintlastic STA and STA Plus)

### FLASHING ASSEMBLY:

- **Standard.** Over a base sheet or bonded to a primed substrate. One ply Flintlastic modified cap sheet, per CT detail.
- **Premium.** Over a base sheet or bonded to a primed substrate. One smooth and one granulated modified membrane flashing, per CT detail.
- **Premium Alternate.** Over a base sheet or bonded to a primed substrate. One smooth modified membrane and CT SmartFlash®, per CT detail.

**Cants:** In angles of roof deck and vertical surfaces, the roofing contractor shall furnish and install an approved cant strip with a minimum 3" face.

\* Available with CoolStar® reflective granules

WARRANTY DURATIONS FOR THIS SPECIFICATION VARY BASED ON ROLL MATERIAL SELECTION; SEE WARRANTY MATRIX.

Applicable local building code may require more stringent installation requirements such as, but not limited to, increased fastener or adhesive densities to meet required wind uplift pressures. Consult local building code and uplift requirements prior to any application of CertainTeed roofing materials. CertainTeed is not responsible for failure to install roofing products per applicable local building codes.

# APP-N-3-T

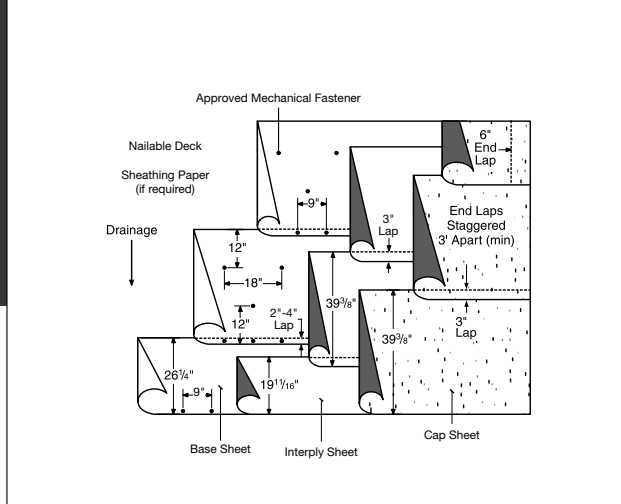

**Base sheet mechanically attached through substrate, adhered interply sheet and torch-welded APP modified cap**

## SUBSTRATE:

- Non-nailable; concrete (Sec. 3.6)
- Re-cover (Sec. 5.0)

## MAXIMUM SLOPE:

Up to 6" : 12" (Sec. 15.3)

## ROOF ASSEMBLY:

Approved base sheet mechanically attached to approved substrate (Sec. 15.0)

Approved interply sheet set in hot asphalt (Sec. 7.0), torch-welded (Sec. 8.0) or self-adhered (Sec. 10.2).

Approved cap sheet, torch-welded (Sec. 8.0).

## SUMMARY OF MATERIALS:

- Base sheet (1 ply)
- Interply sheet (1 ply)
- Cap sheet (1 ply)
- ASTM D 312 asphalt (one mopping)  
(No moppings if base is torch-welded or self-adhered)

## APPROVED BASE SHEETS:

(one of the following)

- All Weather/Empire® Base Sheet
- Flexiglas® Base Sheet
- Flintlastic Base 20
- Flintlastic Poly SMS
- Flintlastic Ultra Poly SMS
- Glasbase™ Base Sheet
- Yosemite® Venting Base Sheet
- Flintlastic APP Base T

## APPROVED INTERPLY SHEETS:

(One of the following)

### Hot Asphalt Applied

- All Weather/Empire Base Sheet
- Flexiglas Base Sheet
- Flintglas Ply 4
- Flintglas Premium Ply 6
- Flintlastic Base 20
- Flintlastic Poly SMS
- Flintlastic Ultra Poly SMS
- Glasbase Base Sheet
- Yosemite Venting Base Sheet

### Torch Welded

- APP Base T
- Flintlastic STA
- Flintlastic STA Plus
- Flintlastic Ultra Poly SMS

### Self-Adhered

- Black Diamond Base Sheet\*\*
- Flintlastic Ultra Glass SA\*\*

## APPROVED CAP SHEETS:

(one of the following)

- Flintlastic GTA\*
- Flintlastic GTA-FR\*
- Flintlastic STA
- Flintlastic STA Plus

## FINAL SURFACING:

For optional surfacing see Section 14.0.

Flintlastic STA and STA Plus (used as cap sheets) require reflective coating.

- FlintCoat A300 or W (required over Flintlastic STA and STA Plus)

## FLASHING ASSEMBLY:

- **Standard.** Over a base sheet or bonded to a primed substrate. One ply Flintlastic modified cap sheet, per CT detail.
- **Premium.** Over a base sheet or bonded to a primed substrate. One smooth and one granulated modified membrane flashing, per CT detail.
- **Premium Alternate.** Over a base sheet or bonded to a primed substrate. One smooth modified membrane and CT SmartFlash®, per CT detail.

**Asphalt:** Type III or Type IV (Sec. 7.0).

**Cants:** In angles of roof deck and vertical surfaces, the roofing contractor shall furnish and install an approved cant strip with a minimum 3" face.

\* Available with CoolStar® reflective granules

WARRANTY DURATIONS FOR THIS SPECIFICATION VARY BASED ON ROLL MATERIAL SELECTION; SEE WARRANTY MATRIX.

Applicable local building code may require more stringent installation requirements such as, but not limited to, increased fastener or adhesive densities to meet required wind uplift pressures. Consult local building code and uplift requirements prior to any application of CertainTeed roofing materials. CertainTeed is not responsible for failure to install roofing products per applicable local building codes.

Consult CertainTeed General Recommendations for noted section references.

**CertainTeed**  
SAINT-GOBAIN  
Commercial Roofing

# APP-N-4-T

## Base sheet mechanically attached through substrate, two adhered interply sheets and torch-welded APP modified cap

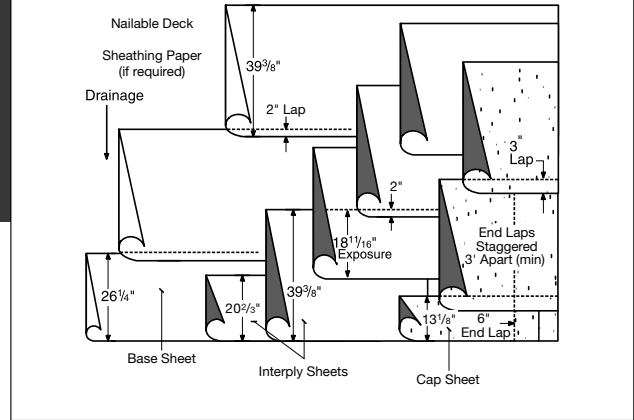

### SUBSTRATE:

- Non-nailable; concrete (Sec. 3.6)
- Re-cover (Sec. 5.0)

### MAXIMUM SLOPE:

Up to 6" : 12" (Sec. 15.3)

### ROOF ASSEMBLY:

Approved base sheet mechanically attached to approved substrate (Sec. 15.0)

Two approved interply sheets set in hot asphalt (Sec. 7.0), torch-welded (Sec. 8.0) or self-adhered (Sec. 10.2).

Approved cap sheet, torch-welded (Sec. 8.0).

### SUMMARY OF MATERIALS:

- Base sheet (1 ply)
- Interply sheets (2 ply)
- Cap sheet (1 ply)
- ASTM D 312 asphalt (twomoppings)  
(No moppings if base is torch-welded or self-adhered)

### APPROVED BASE SHEETS:

(one of the following)

- All Weather/Empire® Base Sheet
- Flexiglas® Base Sheet
- Flintlastic Base 20
- Flintlastic Poly SMS
- Flintlastic Ultra Poly SMS
- Glasbase™ Base Sheet
- Yosemite® Venting Base Sheet
- Flintlastic APP Base T

### APPROVED INTERPLY SHEETS:

(Two of the following)

#### Hot Asphalt Applied

- All Weather/Empire Base Sheet
- Flexiglas Base Sheet
- Flintglas Ply 4
- Flintglas Premium Ply 6
- Flintlastic Base 20
- Flintlastic Poly SMS
- Flintlastic Ultra Poly SMS
- Glasbase Base Sheet
- Yosemite Venting Base Sheet

#### Torch Welded

- APP Base T
- Flintlastic STA
- Flintlastic STA Plus
- Flintlastic Ultra Poly SMS

#### Self-Adhered

- Black Diamond Base Sheet\*\*
- Flintlastic Ultra Glass SA\*\*

### APPROVED CAP SHEETS:

(one of the following)

- Flintlastic GTA\*
- Flintlastic GTA-FR\*
- Flintlastic STA
- Flintlastic STA Plus

### FINAL SURFACING:

For optional surfacing see Section 14.0. Flintlastic STA and STA Plus (used as cap sheets) require reflective coating.

- FlintCoat A300 or W (required over Flintlastic STA and STA Plus)

### FLASHING ASSEMBLY:

- **Standard.** Over a base sheet or bonded to a primed substrate. One ply Flintlastic modified cap sheet, per CT detail.
- **Premium.** Over a base sheet or bonded to a primed substrate. One smooth and one granulated modified membrane flashing, per CT detail.
- **Premium Alternate.** Over a base sheet or bonded to a primed substrate. One smooth modified membrane and CT SmartFlash®, per CT detail.

**Asphalt:** Type III or Type IV (Sec. 7.0).

**Cants:** In angles of roof deck and vertical surfaces, the roofing contractor shall furnish and install an approved cant strip with a minimum 3" face.

\* Available with CoolStar® reflective granules

WARRANTY DURATIONS FOR THIS SPECIFICATION VARY BASED ON ROLL MATERIAL SELECTION; SEE WARRANTY MATRIX.

Applicable local building code may require more stringent installation requirements such as, but not limited to, increased fastener or adhesive densities to meet required wind uplift pressures. Consult local building code and uplift requirements prior to any application of CertainTeed roofing materials. CertainTeed is not responsible for failure to install roofing products per applicable local building codes.



# APP-IN-2-CF

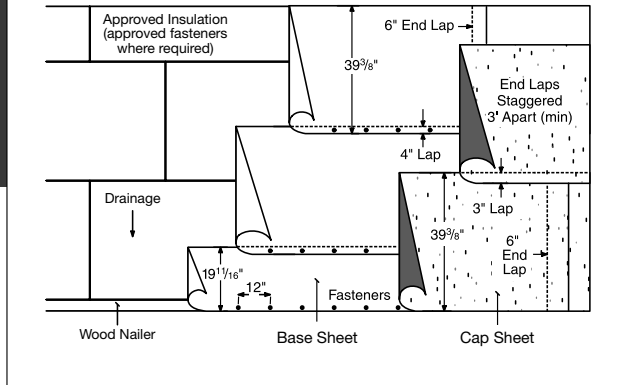

**Base sheet mechanically attached through insulated substrate with heat welded side laps and torch-welded APP modified cap**

## SUBSTRATE:

- Non-nailable; concrete (Sec. 3.6)
- Re-cover (Sec. 5.0)

## MAXIMUM SLOPE:

Up to 6" : 12" (Sec. 15.3)

## ROOF ASSEMBLY:

One or more layers of approved insulation and approved gypsum coverboard:

- Base layer mechanically attached and additional layers mechanically attached or adhered in hot asphalt or approved adhesive.
- Base layer and additional layers adhered in hot asphalt or approved adhesive.
- Vapor retarder/anchor sheets (Sec. 4.7).

Approved base sheet mechanically attached to approved substrate with heat welded side laps (Sec. 15.4.3)

Approved cap sheet, torch-welded (Sec. 8.0).

## SUMMARY OF MATERIALS:

- One or more layers of insulation and approved gypsum coverboard
- Base sheet (1 ply)
- Cap sheet (1 ply)

## APPROVED BASE SHEETS:

- Flintlastic Ultra Poly SMS

## APPROVED CAP SHEETS:

(one of the following)

- Flintlastic GTA\*
- Flintlastic GTA-FR\*
- Flintlastic STA
- Flintlastic STA Plus

## FINAL SURFACING:

For optional surfacing see Section 14.0.

Flintlastic STA and STA Plus (used as cap sheets) require reflective coating.

- FlintCoat A300 or W (required over Flintlastic STA and STA Plus)

## FLASHING ASSEMBLY:

- **Standard.** Over a base sheet or bonded to a primed substrate. One ply Flintlastic modified cap sheet, per CT detail.
- **Premium.** Over a base sheet or bonded to a primed substrate. One smooth and one granulated modified membrane flashing, per CT detail.
- **Premium Alternate.** Over a base sheet or bonded to a primed substrate. One smooth modified membrane and CT SmartFlash®, per CT detail.

**Asphalt:** Type III or Type IV (Sec. 7.0).

**Cants:** In angles of roof deck and vertical surfaces, the roofing contractor shall furnish and install an approved cant strip with a minimum 3" face.

\* Available with CoolStar® reflective granules

WARRANTY DURATIONS FOR THIS SPECIFICATION VARY BASED ON ROLL MATERIAL SELECTION; SEE WARRANTY MATRIX.

Applicable local building code may require more stringent installation requirements such as, but not limited to, increased fastener or adhesive densities to meet required wind uplift pressures. Consult local building code and uplift requirements prior to any application of CertainTeed roofing materials. CertainTeed is not responsible for failure to install roofing products per applicable local building codes.